

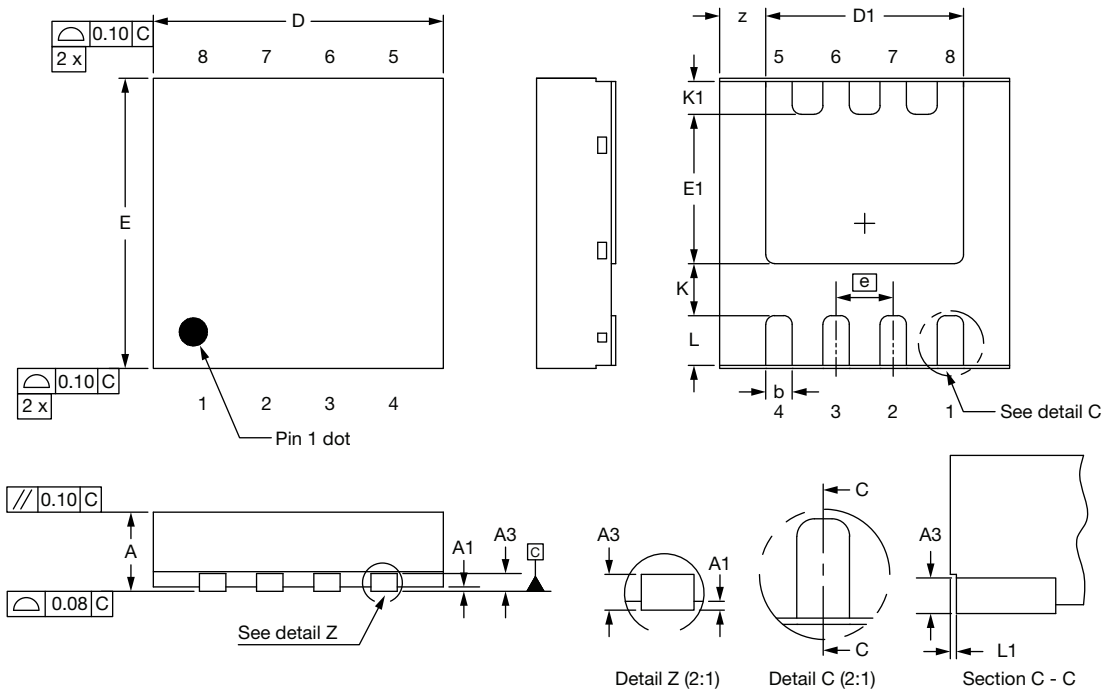

Case Outline for PowerPAK® 1212-8SLW BWL



DIM.	MILLIMETERS			INCHES		
	MIN.	NOM.	MAX.	MIN.	NOM.	MAX.
A	0.82	0.90	0.98	0.032	0.035	0.039
A1	0.00	-	0.05	0.000	-	0.002
A3	0.20 ref.			0.008 ref.		
b	0.25	0.30	0.35	0.010	0.012	0.014
D	3.20	3.30	3.40	0.126	0.130	0.134
D1	2.15	2.25	2.35	0.085	0.089	0.093
E	3.20	3.30	3.40	0.126	0.130	0.134
E1	1.60	1.70	1.80	0.063	0.067	0.071
e	0.65 BSC			0.026 BSC		
K	0.59 ref.			0.023 ref.		
K1	0.38 ref.			0.015 ref.		
L	0.52	0.57	0.62	0.020	0.022	0.024
L1	0.035 ref.			0.001 ref.		
Z	0.525 ref.			0.021 ref.		
ECN: C21-1008-Rev. A, 19-Jul-2021						
DWG: 6090						

Notes

- Use millimeters as the primary measurement
- Dimensioning and tolerances conform to ASME Y14.5M-1994
- The pin #1 identifier must be existed on the top surface of the package by using indentation mark or other feature of package body
- Exact shape and size of this feature is optional
- Package warpage max. 0.08 mm
- Applied only for terminals
- Dimension b applies to plated terminal and is measured between 0.20 mm and 0.25 mm from terminal tip
- N is the number of terminals. Nd is the number of terminals in x-direction. Ne is the number of terminals in y-direction